

Table of contents

Preface.....	2
Safety Instructions.....	3
Intended use.....	7
Operating Instructions	7
Technical data.....	8
Device description.....	8
Installation Instructions	9
Commissioning.....	9
Hose Drainage.....	11
Recommendations for drying with the Comedes Demecto 70.....	11
Maintenance.....	13
Frequently asked questions.....	15

Dear customer,

Thank you for choosing the Demecto 70 from Comedes GmbH.
 You have purchased a powerful dehumidifier that has been developed according to the latest technical standards. To ensure that the appliance will be a faithful servant of yours for a long time to come, we ask you to study the operating instructions, especially the safety instructions, carefully.
 If you still have questions about the device after reading the operating instructions, please do not hesitate to contact us:

E-mail address: service@comedes.com

We welcome any feedback from customers and welcome you to contact us.

With kind regards



Philip Thannhuber
 Managing Director

Comedes Ltd

WARNING:

Please read the instructions carefully before commissioning. Failure to follow the safety instructions and instructions may result in electric shock, fire and/or serious injury. Keep all safety information and instructions for future reference.

Look out! Do not open the unit before the mains plug has been removed from the mains socket. Danger to life through electric shock! Have repairs carried out only by an authorised specialist workshop.



caution, risk of fire

Flammable gas Danger

This symbol indicates that extremely flammable gas is a danger to health and life.

**Observe operating instructions**

This symbol draws your attention to the fact that the operating instructions must be followed before installing and operating the device.

**Observe operating instructions and operating notes**

This symbol draws your attention to the fact that the operating instructions and the operating notes contained therein must be considered and observed.

**Repair instructions, observe technical manual**

Activities on the refrigeration circuit, such as disposal, repairs and maintenance activities, may only be carried out by persons with a relevant certificate of competence and only in accordance with the manufacturer's specifications. Repair instructions and maintenance and disposal information are available from the manufacturer on request.

**Danger**

There is danger to the device or objects in the vicinity of the device.

**Electrical hazard**

shock hazard

Safety Instructions

Do not use any agents other than those recommended by the manufacturer to speed up the defrosting process or to clean the appliance.



The appliance must be stored in a room without continuously operating ignition sources (e.g. naked flames, a gas appliance switched on or an electric heater switched on).



Do not puncture or incinerate.

Note that the refrigerant is odourless.



The device may only be installed, operated and stored in a room with a floor space of more than 12m².



Maintenance may only be carried out in accordance with the manufacturer's instructions.



The unit must be stored in a well-ventilated area in which the room size corresponds to the room area specified for operation.



All work processes that affect safety-relevant

aspects (e.g. repairs) may only be carried out by qualified personnel.

Store the unit in a safe place to avoid electric shock, flame or injury.

Do not immerse this product in water or any other

Fluids.

If the power cord is damaged, it must be replaced by the manufacturer, its service partner or similarly qualified persons to avoid any danger.

Please contact a specialist to have the product repaired. Improper repairs may cause injury to the user.



Disconnect the unit from the power supply before moving, cleaning and even when the product is not in use.

Please operate the product with the specified electrical voltage.

Use this product only as a household appliance and in accordance with its intended use.

Do not place any objects on the product.



To avoid water leakage, please empty the water tank before moving the product.

Do not tilt the appliance, as leaking water may damage the appliance. This appliance may be used by children over 8 years of age and by persons with reduced physical, sensory or mental capabilities or lack of experience and knowledge, provided they are supervised or have received instruction in the safe use of the appliance and understand the risks involved. Children must not play with the device. Cleaning and maintenance by the user must not be carried out by children without supervision. Please position the product at a minimum distance of

Transport, labelling and storage of the equipment

When transporting equipment and parts containing flammable refrigerants, the transport regulations must be observed.



50cm from the wall or other barriers.

The operating temperature range for this instrument is 5-35°C.

Do not operate your dehumidifier in a wet area. The appliance is not splashproof.

Do not place the appliance on a soft, unstable, uneven or wet surface to avoid increased noise, vibration, water leakage or electric shock during operation.



Never insert objects (such as a thin rod) into the unit. This can cause damage to the unit.

Please disconnect the device when you switch it off or do not intend to use it for a longer period of time.

The disposal of units with flammable refrigerants must be carried out in accordance with national regulations.

The maximum number of units that can be stored together is determined by local regulations.

 The device must be stored in such a way that no mechanical damage can occur.

The working area of the device must be at least 12m². It must be ensured that there are no flammable materials in the working area of the device.



Use the on/off switch to switch the unit on and off. Never use the plug to turn the unit on and off.



Do not clean the dehumidifier with water. Never spray the appliance with water. Do not spray the unit with flammable liquids or cleaning agents. Do not touch the ventilation slots. Do not cover the air inlet or outlet.

Do not use the device if the power cord is damaged. Do not use the device in hermetically sealed rooms.

 Always operate the appliance for at least 35 minutes (risk of compressor damage). The automatic switching of the unit in automatic mode is

no problem. Keep the water tank free of foreign objects. Install the unit away from heaters or heat generating devices.



The device must not be used in environments with high dust or chlorine content.

Only use the unit if your power outlet is equipped with an RCD (FI) protection switch.

Never switch the device on or off with wet hands.



Do not attempt to make repairs or other adjustments, both electrical and mechanical, to the unit yourself.

Do not let children play with the packaging, such as plastic sheeting.

Keep a sufficient distance from the air outlet of the unit.



Do not operate the device near explosive, flammable or corrosive materials.



Insert the mains plug firmly and securely into the socket.

Do not operate the dehumidifier via a multiple socket or extension cord.

Appropriate use



The dehumidifier is only intended for dehumidifying privately used rooms (e.g. living rooms, bedrooms, storage rooms or cellars). The user must comply with the operating parameters specified in this manual.

The machine may only be used for its intended purpose. Any other use beyond this is not in accordance with its intended purpose. The user/operator and not the manufacturer is liable for any damage or injury of any kind caused by this.

Operating instructions



The device is designed for a temperature range between 5 and 35°C. Below 5°C the humidity tends to be very low, so you do not need to use a dehumidifier. Above 35°C, the overheating protection may automatically switch off the unit. The unit is not approved for operation outside the temperature range.

The dehumidifier warms the air so that it can dehumidify optimally. Therefore the room temperature can rise by 1-2 degrees. This is quite normal and increases the efficiency of the unit.

In order to work in an energy-efficient manner, the unit switches off automatically when the set humidity is reached. If the humidity rises again, the unit switches on again automatically.

Always take the device from the front if you want to carry it.

When the water tank is full, the appliance switches off automatically.

Technical data

Product name	: Comedes Demecto 70
Voltage:	220~240V 50 Hz
Nominal power:	800W
Dehumidification capacity:	70 l/ day (30°C 80% humidity)
Dehumidification capacity (max.):	75 l/ day
Weight:	19,5 kg
Permissible operating temperature:	5-35°C
Working area humidity:	30-90% RH
Coolant / quantity:	R290/153g
Refrigerant group	L3
Water tank size:	4,8 l
Maximum room size dehumidification:	120m ² (Rh. 2,3m)
Maximum room size for keeping dry:	240 m ² (Rh. 2,3m)
Dimensions:	405 x 632 x 268 mm
Noise level:	< 51 dB
Approved work area:	
Low pressure side:	0.6 MPa(6kgf/cm ²)
High pressure side:	2.5 MPa(25kgf/cm ²)
Maximum working pressure:	4.0 MPa(40kgf/cm ²)

Figure 1



Figure 2

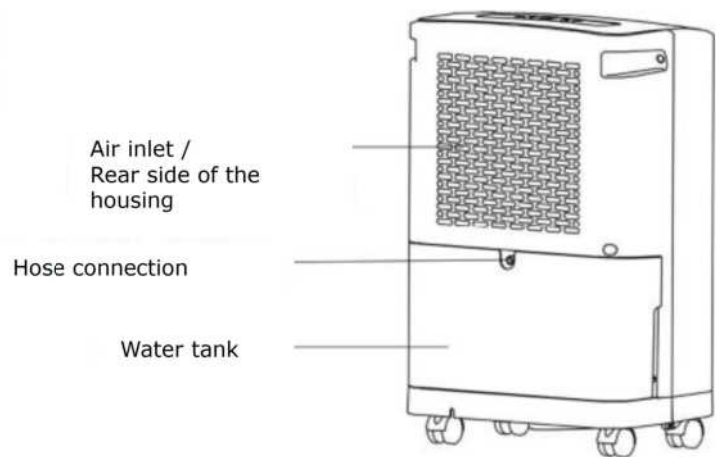

Installation Instructions



Operate the device only in rooms with at least 12m² floor space

Remove all adhesive tapes that were used for transport securing.

Check that the device is standing securely on a dry surface.

Make sure that the unit cannot cause water damage even if the water tank leaks.

Before starting up the appliance, always leave it in its final position for at least 2 hours to allow the coolant to cool down and to avoid the risk of compressor damage.

Check that the device is not exposed to direct sunlight. Check the float for correct seating and ease of movement.

Make sure that the water tank is correctly seated.

Make sure that the power outlet is equipped with an RCD circuit breaker (ground fault circuit interrupter). If

If you are not sure whether this is the case, you can ask your electrician or use a personal protection plug (available at the hardware store).

To save power and avoid potential hazards, disconnect the unit when not in use.

Commissioning



Before connecting the power plug, check the cable for damage. The unit may only be operated with a faultless mains cable. Plug in the mains cable and switch on the unit with the on/off switch.



WARNING: Always allow the appliance to run for at least 35 minutes before switching it off and never switch it off and on continuously. There would be a risk of compressor damage.

Leave the Comedes Demecto 70 to stand for at least 3 minutes after switching off, without moving the appliance, so that the water in the drip tray can drain completely. The higher the humidity in a room and the higher the temperature in it, the better the Comedes Demecto 70 can dehumidify the air. Therefore, the compressor will generate heat and thus warm up the room air. This is quite normal and need not worry you.

Control panel

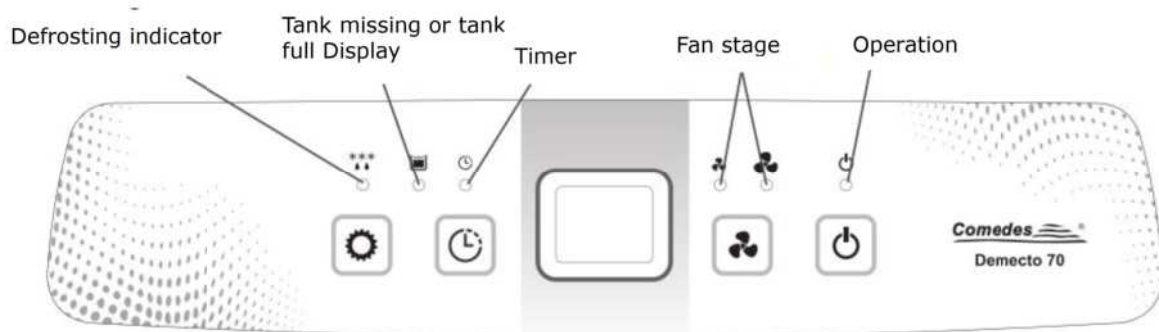

ON / OFF switch:

Press this button to turn the unit on and press it again to turn the unit off. When the unit is in operation, the "Operation" LED is on continuously. If the set room air humidity is reached, the "Operation" LED flashes.

Speed:

Press this button to switch between the two fan levels.

Timer:

With the timer you can set the start or running time of the device. Times between 1 and 24 hours can be selected.

When the time has expired, the device switches on or off.

When the LED of the timer is off, the unit runs in continuous operation.

To set a start time, press the timer button when the unit is in standby. To set the running time of the unit, press the Timer button when the unit is switched on. After you set the running time, it will be shown on the display for about 5 seconds, then the current humidity level will be shown again. If you press the Timer button again, the current running time will be shown on the display for 5 seconds.

Humidity adjustment:

The unit is equipped with a modern hygostat (humidity controller) and the compressor switches off automatically when the desired humidity is reached. If the humidity in the room rises again, the Comedes Demecto 70 switches on again



automatically. By repeatedly pressing the " " button, a target humidity of CO, 30%, 35%, 40%, 45%, 50%, 55%, 60%, 65%, 70%, 75%, 80%, 85%, 90% and AU can be set.

The hysteresis of the device is about 3%. During operation, the current humidity is shown on the display. If the current humidity is below 35% the display shows "LO". If the humidity is above 95%, the display shows "HI".

memory function

The unit has a memory function that saves the fan speed and target humidity settings when the unit is turned off. As soon as the dehumidifier is switched on again, it starts up with the saved settings.

Continuous operation (CO.):

With the "CO" setting, the unit dehumidifies at maximum capacity and does not switch off until the tank is full.

Comfort operation (AU):

With this setting, the unit operates in an automatic mode influenced by the temperature.

1. at a temperature below 5°C the compressor stops.
2. at a temperature between 5°C and 20°C the target humidity is automatically of 60%.
3. at a temperature between 20°C and 27°C a target humidity is automatically set of 55%.
4. at a temperature above 27°C a target humidity of 50% is automatically stored.



Attention: After setting a value within the no further button for the next 5 seconds to accept the setting

Empty water tank:

When the water tank is full, the Comedes Demecto 70 switches off automatically and the red LED ("Tank Full" indicator, Fig. 3) lights up. You must empty the water tank to be able to use the Demecto 70 again.

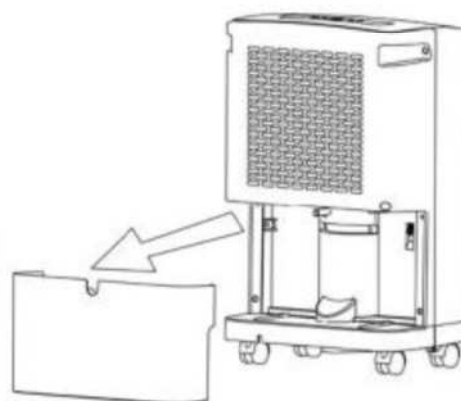

Hose drainage

The Comedes Demecto 70 can also be operated with a drainage hose. To do this, remove the water tank and attach a drainage hose Ø12mm (not included in the scope of delivery). Place it in the recess on the tank, replace the tank and lead the hose into a drain channel.



Make sure that the drain is not higher than the connection on the appliance, so that the water can drain away undisturbed.

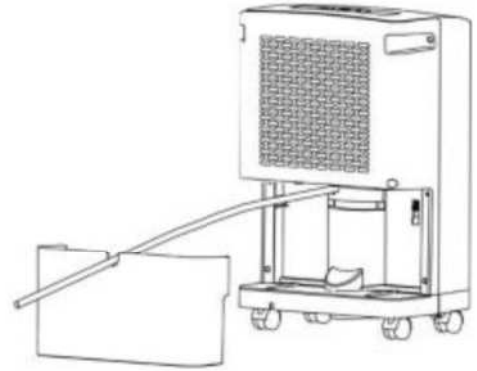

Recommendations for drying with the Comedes Demecto 70

To achieve the best possible dehumidification result with the Demecto 70 at to achieve the lowest possible energy consumption, we provide the following information:

Since this manual can only provide limited help, we recommend that you obtain further information at: www.luftentfeuchter-tipps.de.

Basics for dehumidification with the Comedes Demecto 70

The dehumidifier works similar to a refrigerator with a refrigerating machine. This creates a cold surface (on the evaporator) on which water condenses. Depending on air humidity and ambient temperature, the water condenses at the dew point temperature. To enable the dehumidifier to dehumidify, the cold surface must be below the dew point temperature. Since the water would freeze at negative dew point temperatures, the dehumidifier can only work with positive dew point temperatures. To ensure this, the dehumidifier is equipped with a modern, temperature-controlled automatic defrosting system that keeps the evaporator temperature between 0 and 5°C. To be able to dehumidify sensibly, the dew point temperature should be above 5°C. If the dew point temperature is below this, dehumidification is either not possible at all or only very inefficiently. With the following table you can determine the dew point temperature in your case. If the dew point temperatures are too low, heating is recommended. Gas radiant heaters are not suitable in this case.

Raumtemp.	20%	25%	30%	35%	40%	45%	50%	55%	60%	65%	70%	75%	80%	85%	90%	95%
30°C	4,6	7,8	10,5	12,9	14,9	16,8	18,4	20	21,4	22,7	23,9	25,1	26,2	27,2	28,2	29,1
29°C	3,8	7,2	9,7	12	14	15,9	17,5	19	20,4	21,7	23	24,1	25,2	26,2	27,2	28,1
28°C	3	6,1	8,8	11,1	13,1	15	16,6	18,1	19,5	20,8	22	23,2	24,2	25,2	26,2	27,1
27°C	2,1	5,3	8	10,2	12,2	14,1	15,7	17,2	18,6	19,9	21,1	22,2	23,3	24,3	25,2	26,1
26°C	1,3	4,5	7,1	9,4	11,4	13,2	14,8	16,3	17,6	18,9	20,1	21,2	22,3	23,3	24,2	25,1
25°C	0,5	3,6	6,2	8,5	10,5	12,2	13,9	15,3	16,7	18	19,1	20,3	21,3	22,3	23,2	24,1
24°C	-0,3	2,8	5,4	7,6	9,6	11,3	12,9	14,4	15,8	17	18,2	19,3	20,3	21,3	22,3	23,1
23°C	1,1	1,9	4,5	6,7	8,7	10,4	12	13,5	14,8	16,1	17,2	18,3	19,4	20,3	21,3	22,2
22°C	-2	1,1	3,6	5,9	7,8	9,5	11,1	12,5	13,9	15,1	16,3	17,4	18,4	19,4	20,3	21,2
21°C	-2,8	0,2	2,8	5	6,9	8,6	10,2	11,6	12,9	14,2	15,3	16,4	17,4	18,4	19,3	20,2
20°C	-3,6	-0,3	1,9	4,1	6	7,7	9,3	10,7	12	13,2	14,4	15,4	16,4	17,4	18,3	19,2
19°C	-4,4	-1,4	1	3,2	5,1	6,8	8,3	9,8	11,1	12,3	13,4	14,5	15,5	16,4	17,3	18,2
18°C	-5,3	-2,3	0,2	2,3	4,2	5,9	7,4	8,8	10,1	11,3	12,5	13,5	14,5	15,4	16,3	17,2
17°C	-6,1	-3,1	-0,6	1,4	3,3	5	6,5	7,9	9,2	10,4	11,5	12,5	13,5	14,5	15,3	16,2
16°C	-6,9	-4	-1,4	0,5	2,4	4,1	5,6	7	8,2	9,4	10,5	11,6	12,6	13,5	14,4	15,2
15°C	-7,7	-4,8	-2,2	-0,3	1,5	3,2	4,7	6,1	7,3	8,5	9,6	10,6	11,6	12,5	13,4	14,2
14°C	-8,6	-5,7	-2,9	-1	0,6	2,3	3,7	5,1	6,4	7,5	8,6	9,6	10,6	11,5	12,4	13,2
13°C	-9,4	-6,5	-3,7	-1,9	-0,1	1,3	2,8	4,2	5,5	6,6	7,7	8,7	9,6	10,5	11,4	12,2
12°C	-10,2	-7,4	-4,5	-2,6	-1	0,4	1,9	3,2	4,5	5,7	6,7	7,7	8,7	9,6	10,4	11,2
11°C	-11,1	-8,2	-5,2	-3,4	-1,8	-0,4	1	2,3	3,5	4,7	5,8	6,7	7,7	8,6	9,4	10,2
10°C	-11,9	-9,1	-6	-4,2	-2,6	-1,2	0,1	1,4	2,6	3,7	4,8	5,8	6,7	7,6	8,4	9,2
8°C	-13,6	-10,8	-8,5	-6,5	-4,8	-3,2	-1,8	-0,5	0,67	1,8	2,83	3,82	4,77	5,66	6,48	7,32
6°C	-15,2	-12,5	-10,2	-8,3	-6,6	-4,9	-3,07	-2,1	-1,05	-0,08	0,85	1,86	2,72	3,62	4,48	5,38
4°C	-16,9	-14,2	-12	-10	-8,4	-6,11	-4,88	-3,69	-2,61	-1,79	-0,88	-0,09	0,78	1,62	2,44	3,2
2°C	-18,6	-15,9	-13,7	-11,8	-10,2	-7,77	-6,56	-5,43	-4,4	-3,16	-2,48	-1,77	-0,98	-0,26	0,47	1,2
0°C	-20,2	-17,6	-15,5	-13,6	-12	-10,5	-9,2	-7,9	-6,8	-5,8	-4,8	-3,9	-3	-2,2	-1,4	0,7

Drying in case of problems with condensation

Condensation dampness usually occurs in cellars when damp air enters the cellar in summer and condenses on the cold cellar walls. We recommend to dehumidify the cellar room by room first in continuous operation. Let the unit run in continuous operation at first until you notice that the amount of water that you drain from the tank every day becomes less. Now place the unit in the next room. Once you have dried all rooms, we recommend that you select a central installation location and operate the unit in automatic mode. We recommend a humidity setting of about 50-60%. This type of dehumidification is more energy-efficient than dehumidifying immediately in automatic mode, as the unit then switches off and on very frequently.

Drying in case of construction defects or water damage

In the case of construction defects and water damage, the cause should first be eliminated. Afterwards, the rooms can be dried with condensation dryers, such as the Demecto 70. Here, the dehumidifier is operated continuously. The ambient temperature should be at least 20°C (no more than 27°C). If is necessary, can be heated by electric heaters. Gas heaters are not suitable! To create the necessary air circulation, the use of fans in the room helps. Please note that depending on the construction defect, drying of the insulation layer may also be necessary. This must be carried out by a specialist company.

Recommended air humidity for rooms

Basically this depends on the ambient temperature. The higher the temperature of the room, the lower the relative humidity should be set, otherwise mould growth in the room is favoured. The pleasant air humidity varies, depending on the ambient temperature, from 35% to 65% relative humidity.

The following diagram gives an indication of which air humidity is optimal at which ambient temperatures.

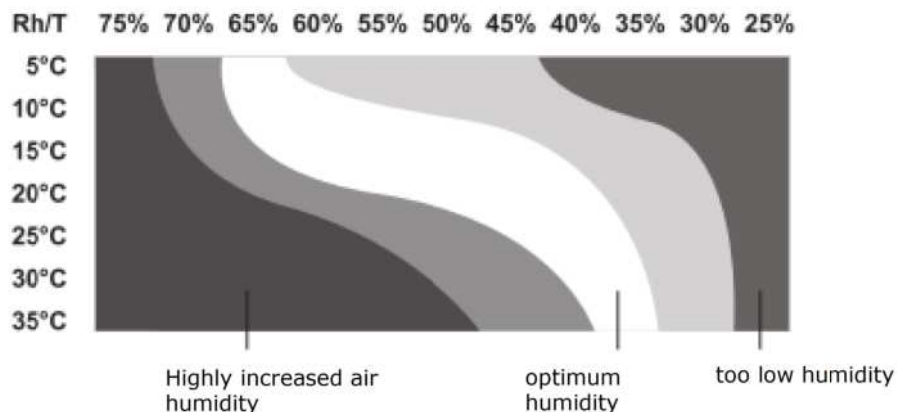

The diagram assumes that temperatures $\geq 20^{\circ}\text{C}$ are living rooms and temperatures $\leq 20^{\circ}\text{C}$ are cellar rooms.

Maintenance

A maintenance log must be kept for the operation of the device as follows:

Maintenance intervals:

Maintenance and service interval	before each commissioning	if required	At least every 2 weeks	At least every 4 weeks	At least every 6 months	At least annually
Check air inlet and outlet and remove impurities. (Fig. 2, Fig1.)	X			X		
Exterior cleaning		X				X
Visual inspection of the water outlet (hose connection) for contamination		X				X
Check air filter for dirt and foreign bodies, clean or replace if necessary	X		X			
Check the unit for damage (power cable, housing, tank, fan wheel)	X					
Trial run						X
Empty tank or check hose drainage		X				

Maintenance log for Comedes Demecto 70:

Serial number:

Maintenance and service interval	1	2	3	4	5	6	7	8	9	10	11	12	13	14	15
Check air inlet and outlet and remove impurities.															
Exterior cleaning															
Visual inspection of the water outlet (hose connection) for contamination															
Check air filter for dirt and foreign bodies, clean or replace if necessary															
Check the unit for damage (power cable, housing, tank, fan wheel)															
Check fastening screws															
Trial run															
Empty tank or check hose drainage															

1. Date: Signature	2. Date: Signature	3. Date: Signature	4. Date: Signature
5. Date: Signature	6. Date: Signature	7. Date: Signature	8. Date: Signature
9. Date: Signature	10. Date: Signature	11. Date: Signature	12. Date: Signature
13. Date: Signature	14. Date: Signature	15. Date: Signature	16. Date: Signature

Check air inlet and air outlet

The unit draws in air from the rear (Fig. 2) and blows it out again at the top. (Fig. 2) Make sure that the air inlet and outlet are not blocked and check this each time you start up the unit. Make sure that no objects or walls obstruct the air inlet or outlet and observe the distance rules.

Check air filter:

This should be done every 2 weeks.

To do this, switch off the unit, disconnect the mains cable and remove the water tank. You can now pull the filter downwards out of the unit.

Rinse the filter with warm (maximum 40°C) clear water and let it dry. Make sure that the filter is not exposed to high temperatures and do not use cleaning agents or other substances (such as petrol or alcohol). You can then reattach it to the unit.

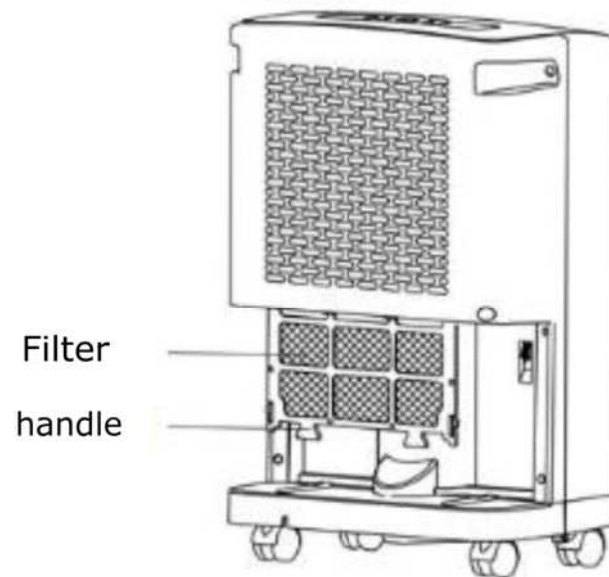

Check the drainage hose:

Check the hose used for hose drainage regularly for blockages and damage. If the hose is clogged or damaged, replace it with a new one.

Frequently asked questions (FAQ)

Current operating instructions can be found at: <http://blog.comedes.com>

Device does not start working.

1. is the device correctly plugged in?
2. is the water tank correctly positioned?
3. is the red tank "full" indicator lit up?
4. did the fuse blow?
5. if the above points are ok, then try again in 10 minutes
6. if the device still does not work, please contact service@comedes.com

The dehumidification capacity is too low.

1. is the dust filter dirty?
2. is the air inlet or outlet blocked?
3. is the temperature or humidity too low? (Cf. dew point table on page 12.)

The unit does not switch off in automatic mode.

1. are the windows and doors closed?
2. does any device produce steam in this room?
- Three. Is the room too big?

The device is very loud.

1. is it standing on firm, suitable ground?
2. does the unit touch the room wall?
3. in the case of tiled floors, it is advisable to lay a piece of carpet underneath.

The fuse blows all the time.

The RCD (FI) circuit breaker trips continuously. Stop operation and contact us at:

service@comedes.com

The power cord or plug becomes disproportionately warm.

Stop operating and contact us at: service@comedes.com

There are objects or water in the device.

Stop operating and contact us at: service@comedes.com

Error Code	Error	Procedure
E1	Temperature sensor defective	Please contact service@comedes.com
E2	Humidity sensor defective	Please contact service@comedes.com



This product must not be disposed of with household waste. This dehumidifier must be disposed of at a recycling centre for electronic and electrical equipment. For more information on the relevant collection points, please contact your local authority or town council, or Comedes GmbH